

Distributon cabinet with special depth 470mm

usable depth up to lock: 403mm

inspected according VDE 0660 Teil 500 / IEC 439-1
inspected by TÜV according DIN EN 61439-5

protection class of cabinet : IP44
class of protection II (with electrical insulation)
made of : fibreglass-reinforced polyester
(SMC process), IEC-695-2-1, halogen-free
colour : grey, similar to RAL 7035
lock: single swing handle left 2/3 door
single swing handle right 1/3 door
(with profile cylinder lock inside)

optional:

- steel installation panel zinc platet
- protection class IP54
- RAL-painting on the outside
- PVC installation panel 6mm

matching base: 2NS470

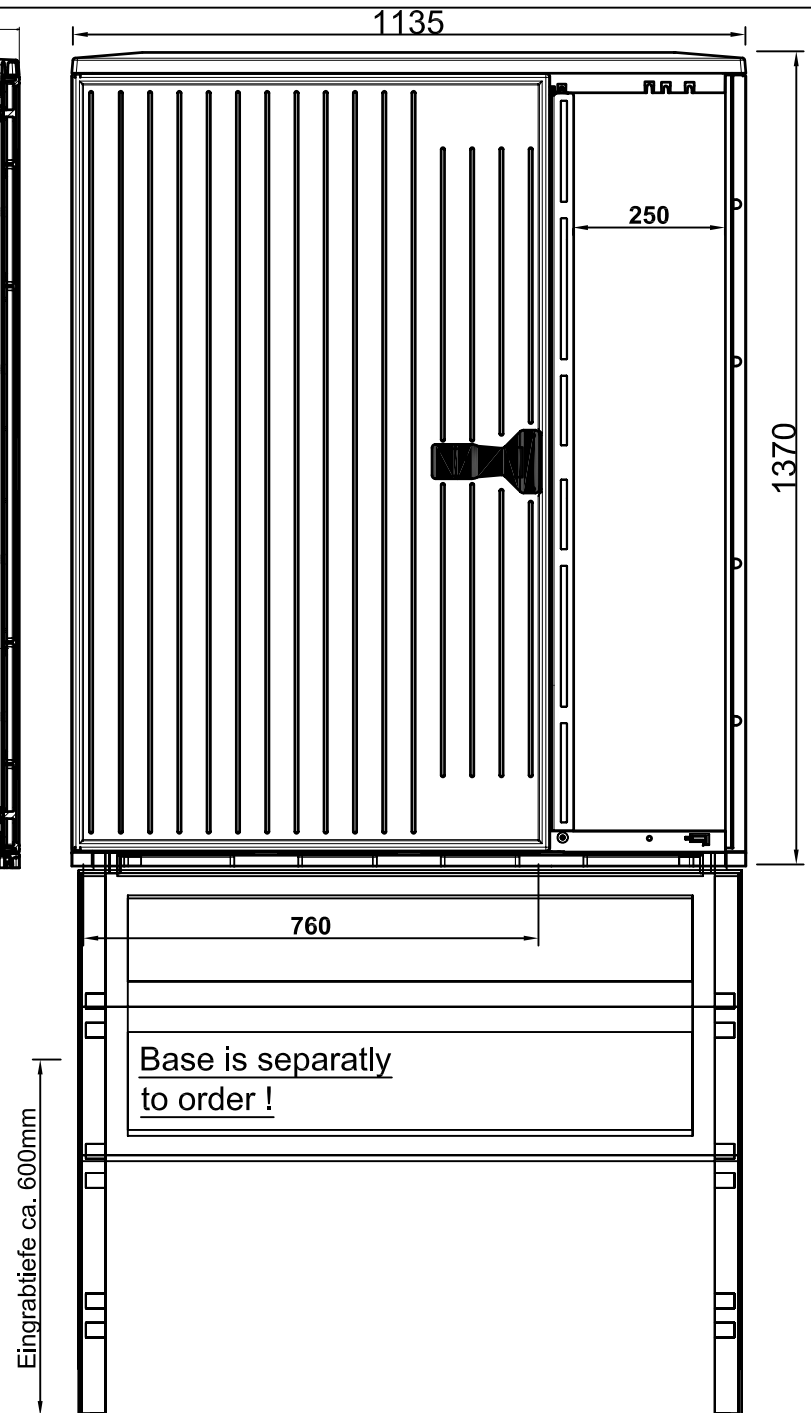
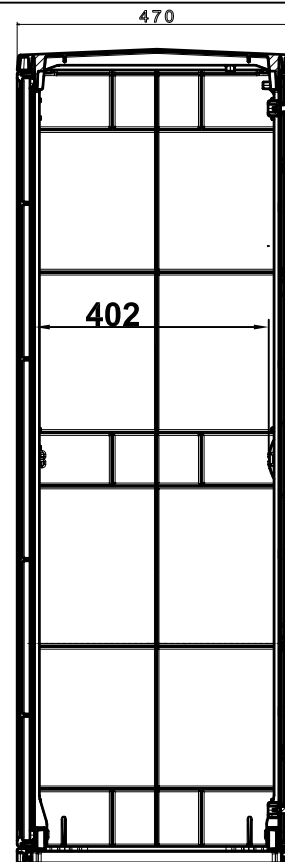

			Datum	19.12.2013	Project:Empty cabinet Best.-Nr2S1300ES2ES1-470	Ang.-Nr.: Auf.-Nr.:
			Bearb.	M.Biermann		
			Gepr.			
Zust.	Anderung	Datum	Name	Norm	Urspr.	Ers.f.
						Ers.d.



GSAB
Elektrotechnik GmbH

Lindenstraße 23 Tel: 49/03636/7614-76 Bl. 1 v.
99718 Greußen Fax: 49/03636/7614-30 1 Bl.